



Velocity Advantage Starting Platform

ASSEMBLY AND INSTALLATION INSTRUCTIONS



SRS AUSTRALIA, PTY LTD
12 Enterprise St
Richlands QLD 4077
Australia
Phone 07 3812 2283 • Fax 07 3812 1187
www.srsmith.com/au

S.R. SMITH, LLC
CORPORATE HEADQUARTERS
P.O. Box 400 • 1017 S.W. Berg Parkway
Canby, Oregon 97013
USA
Phone (503) 266 2231 • Fax (503) 266 4334
www.srsmith.com

Table of Contents

| | |
|--|----|
| INTRODUCTION..... | 2 |
| VELOCITY ADVANTAGE LAYOUT..... | 4 |
| PARTS LIST..... | 5 |
| VELOCITY ADVANTAGE ASSEMBLY INSTRUCTIONS | 6 |
| VELOCITY ADVANTAGE INSTALLATION INSTRUCTIONS | 10 |
| BACKSTROKE LEDGE ADJUSTMENT | 10 |
| WARRANTY & PRODUCT REGISTRATION INFORMATION..... | 11 |

INTRODUCTION



DANGER – FAILURE TO FOLLOW THESE WARNINGS, INSTRUCTIONS, AND THE OWNER’S MANUAL MAY RESULT IN SERIOUS INJURY OR DEATH.

The Velocity Advantage Starting Platform is designed for use on competitive or municipal pools. Proper installation, use, and maintenance are essential for proper operation and to reduce the risk of serious injury or death.

All national and local building codes must be followed. This includes any applicable requirements for size of concrete footing and bonding or electrical codes.

Check entire box and inside all packing materials for parts. Before beginning assembly, read the instructions and identify parts using the figures and parts listed in this document. It is critical that all parts be carefully inspected by the installer prior to installation to ensure that no damage occurred in transit and that a damaged part is not used. Proper installation cannot be overstressed, as an improper installation voids S.R. Smith’s warranty and may affect the safety of the user.

Installer must give the owner the Velocity Advantage Starting Platform installation manual.

VELOCITY ADVANTAGE LAYOUT

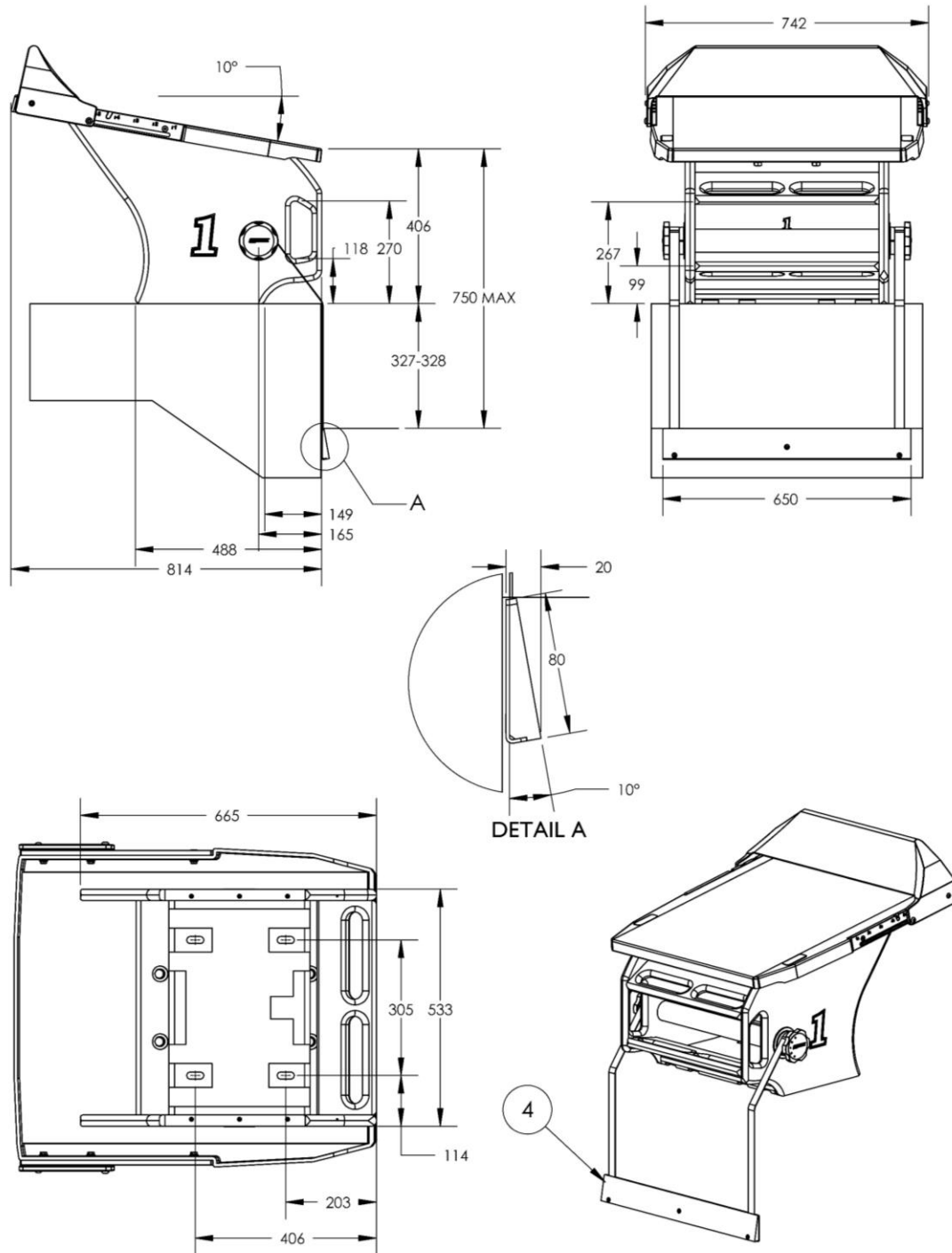

Figure I | Velocity Advantage Dimensions

PARTS LIST

| ITEM NO. | QTY. | PART NO. | DESCRIPTION |
|----------|------|----------|---------------------------------------|
| 1 | 1 | 03-601 | FRAME LEFT SIDE |
| 2* | 1 | 03-602 | FRAME RIGHT SIDE |
| 3* | 1 | 03-603 | FRAME TOP |
| 4* | 2 | 03-604 | BACKSTROKE START HANDLE |
| 5* | 1 | 03-603 | FRAME SUPPORT |
| 6* | 1 | 03-606 | FRAME BASE |
| 7* | 1 | 26-100 | BACKSTROKE START ASSEMBLY |
| 8* | 12 | 5-530 | #10 X 2.5" FLAT HEAD SOCKET CAP SCREW |
| 9 | 2 | 5-531 | 10-24 x 1" SET SCREW |

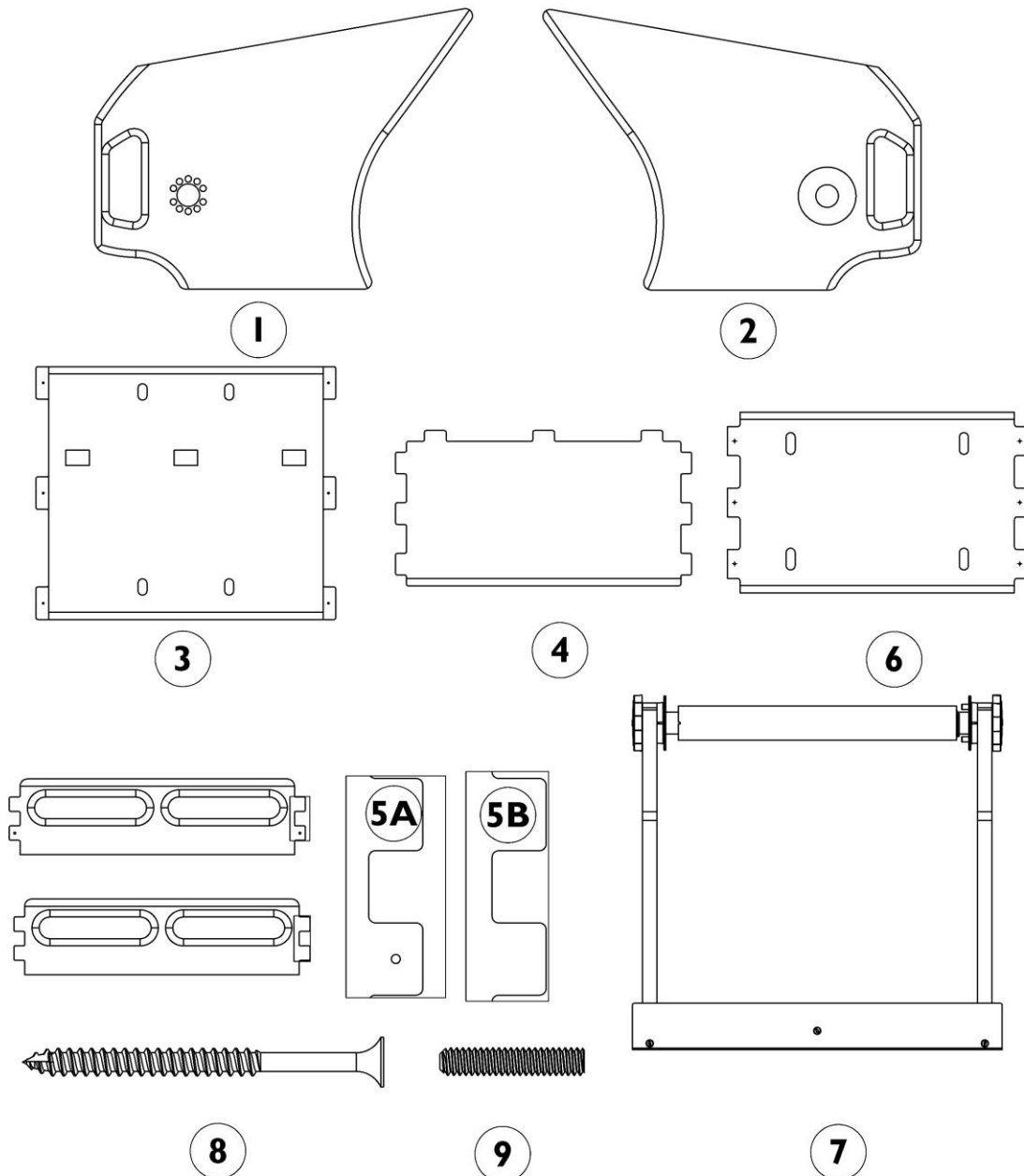

Figure 4 | Velocity Advantage Parts

VELOCITY ADVANTAGE ASSEMBLY INSTRUCTIONS

I) **Disassemble backstroke start wedge.**

Directions like left and right are based on a viewpoint facing the pool.

- I.1) Unbox the backstroke start wedge. Ensure all of its components are included. Unwind the spool so strap is not wrapped around.
- I.2) Use a Phillips head screwdriver to remove a screw from each spool end.
- I.3) Remove the spool ends from the shaft Refer to Figure 5.

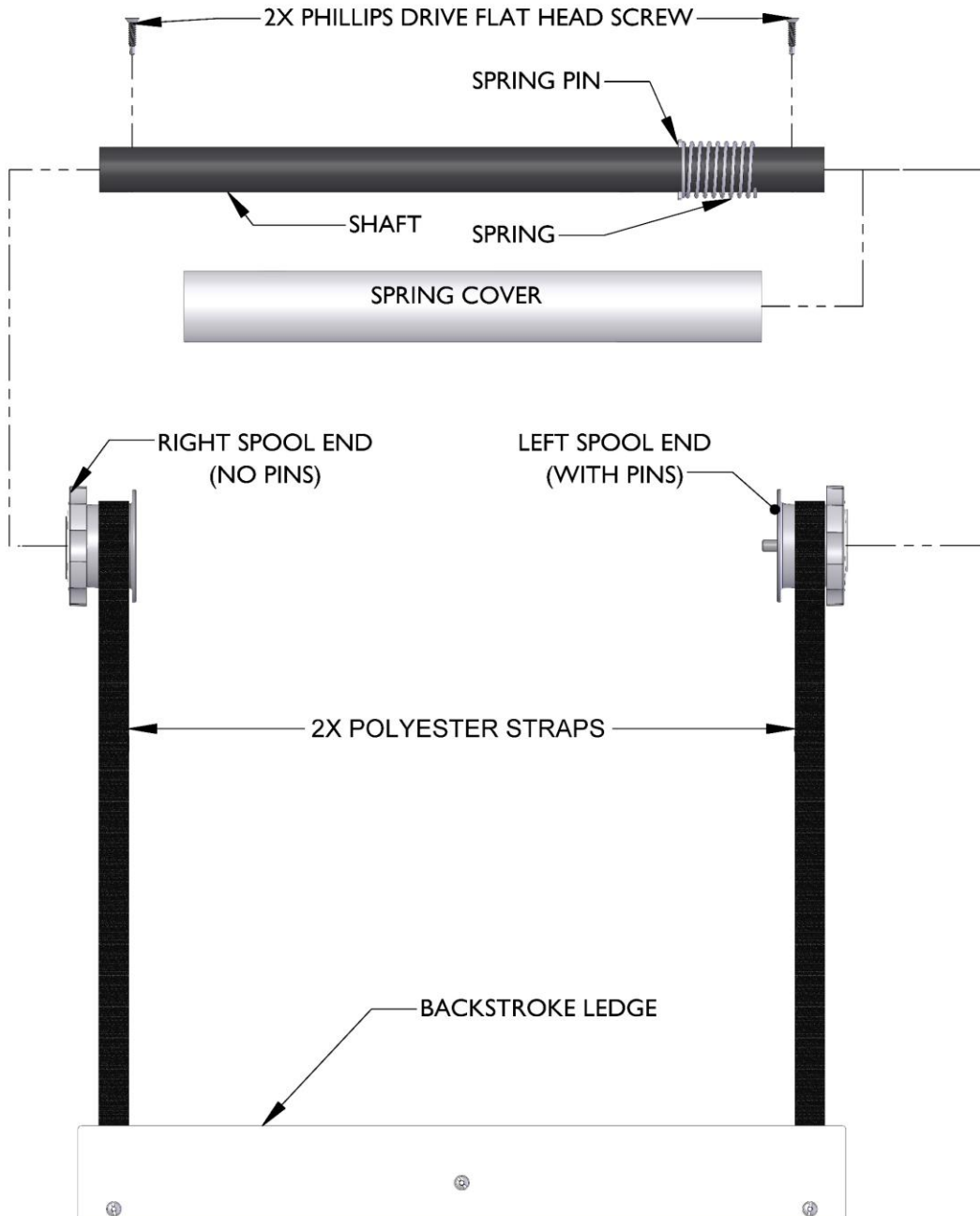
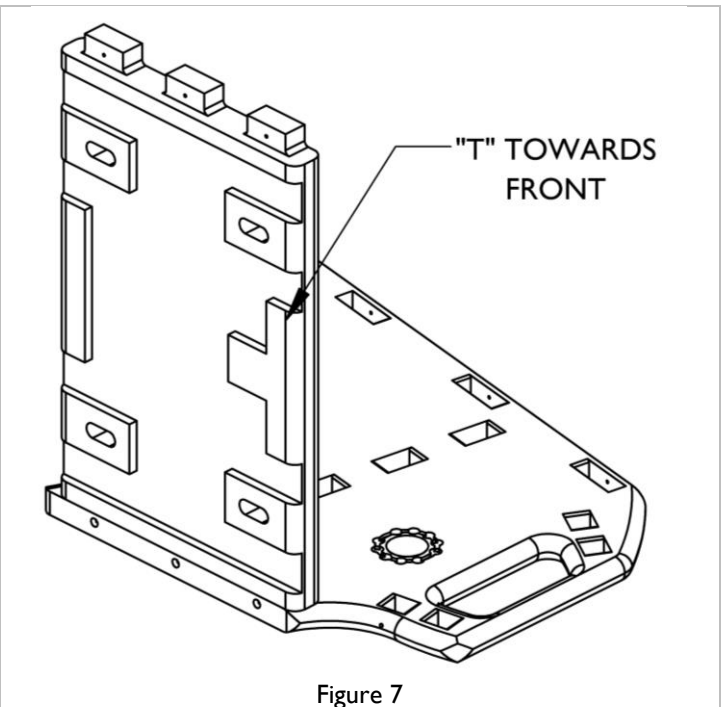
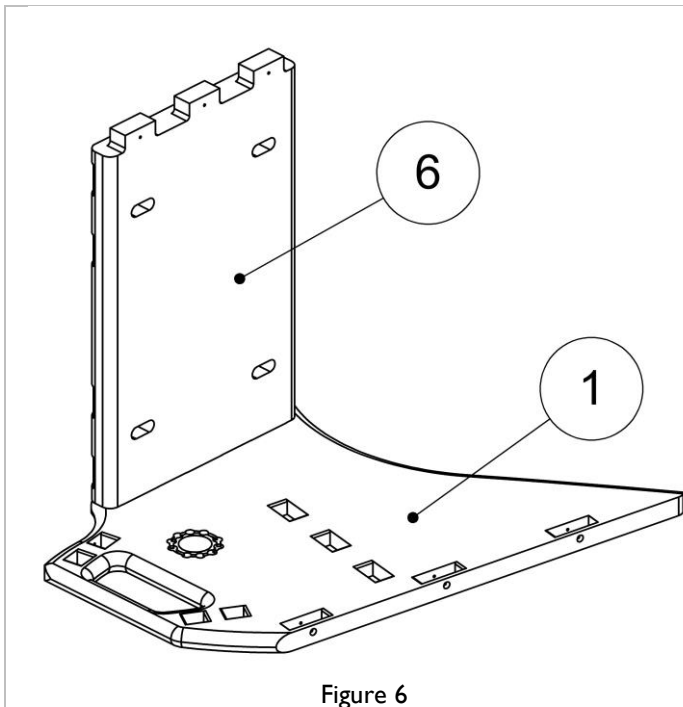

Figure 5

2) Assemble the Velocity Advantage frame

- 2.1) Place the left side (with the hole pattern) on a flat surface, number-side down.
- 2.2) Insert the base into the three holes as shown, flat surface towards the side piece. Refer to Figure 6 and Figure 7.



- 2.3) Insert the shaft and spring into the left frame's hole so the spring pin is near the left side. Refer to Figure 8.
- 2.4) Insert the PVC tube into the left side so the slotted end is away from the left side. Nest into the left side. Refer to Figure 9.

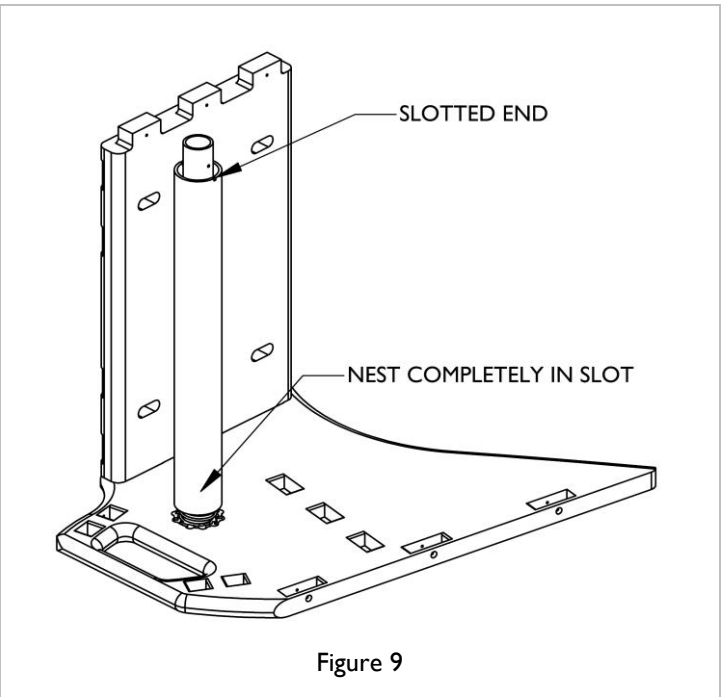
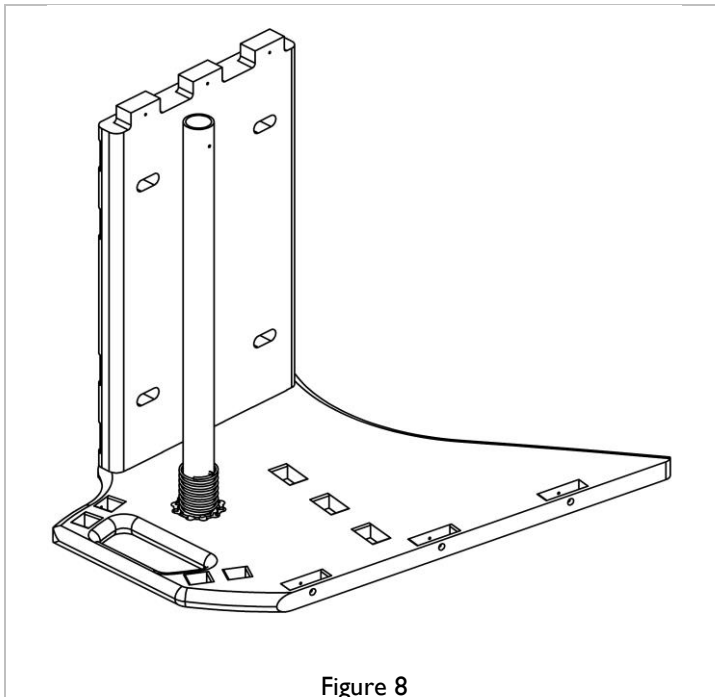

- 2.5) Insert the backstroke handles into the pockets shown, rounded edges toward the outside of the block. Align the holes as shown in detail in Figure 10.
- 2.6) Insert the frame support into the frame top as shown, with the large number toward the back edge and the small number toward the short edge. Refer to Figure 11.

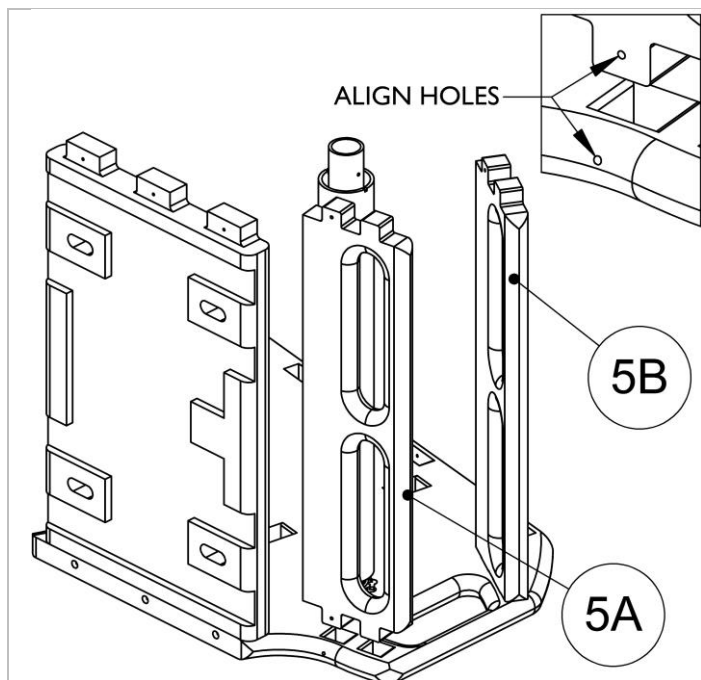

Figure 10

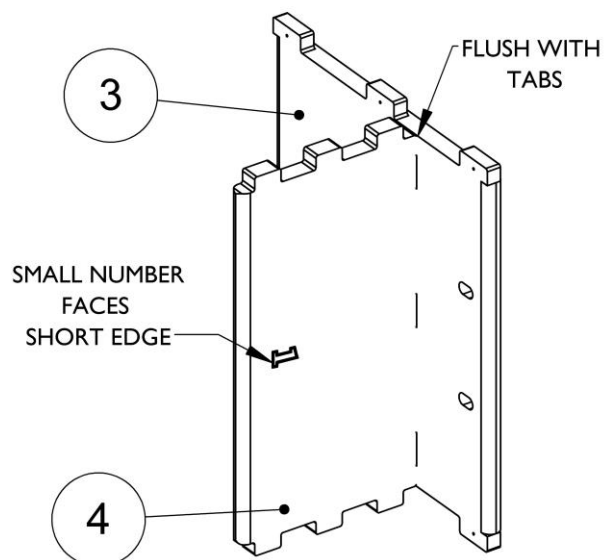

Figure 11

- 2.7) Insert both pieces into the left frame as shown in Figure 12.
- 2.8) Nest the right side on top and use a dead blow hammer or long clamp as necessary to ensure the frame is tightly assembled. Rotate the shaft cover so the right frame is seated as shown in detail in Figure 14.

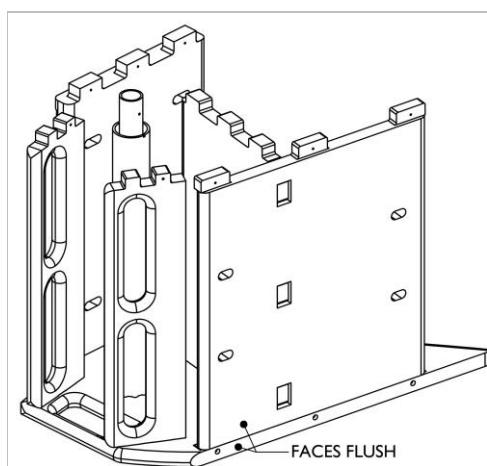

Figure 12

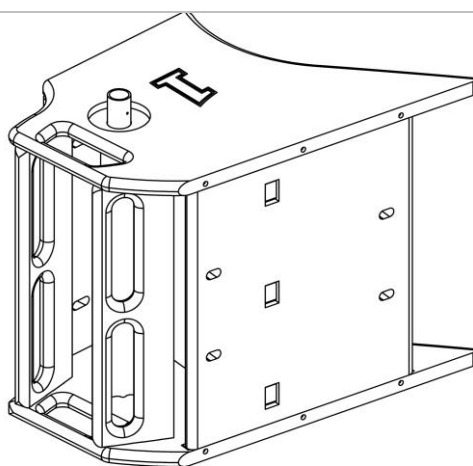

Figure 13

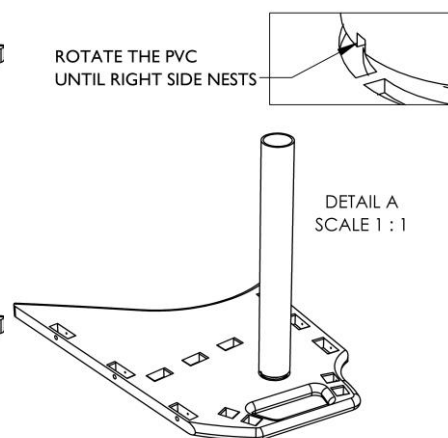

Figure 14

3) Fasten the Velocity Advantage frame.

- 3.1) Rotate the advantage so its base is on the bottom.
- 3.2) Use an impact driver or drill and No. 2 square drive bit to fasten top plate to sides with 6 screws in the countersunk holes on the sides. (8).
- 3.3) Flip over starting block and fasten base to sides with 6 screws (8).
- 3.4) Fasten bottom backstroke handle to each sides with a set screw (9) using a 3/32" Allen key.

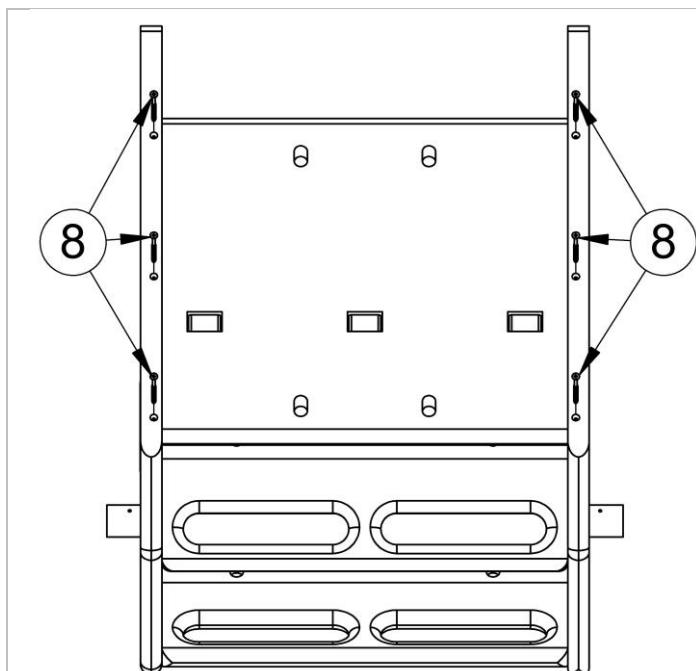

Figure 15

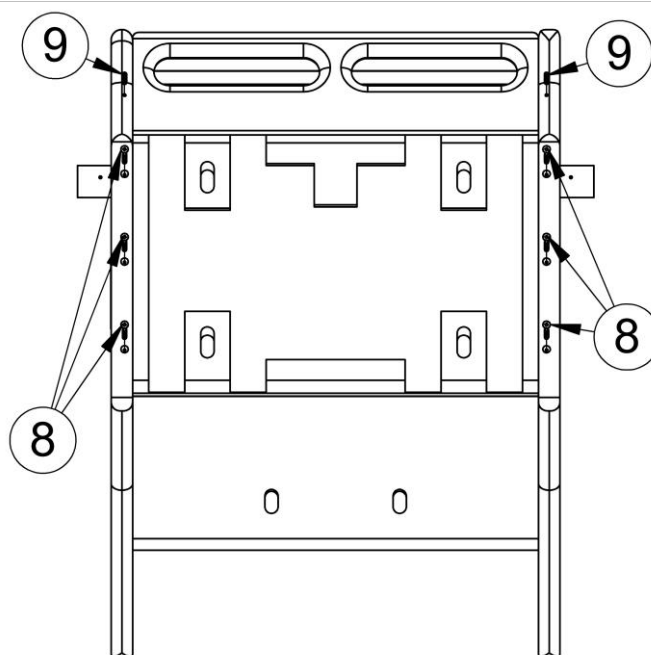

Figure 16

4) Set up backstroke start.

- 4.1) Reattach spool ends to shaft using screw removed in Step 1.3. Left spool end has knurled pins and is on the side of the starting block with the circular hole pattern. Ensure both straps are hanging freely when refastening, so straps are equal length.
- 4.2) Pull the left spool cap so the pin clears the frame and rotate shaft as shown, under the spool end then over the top.

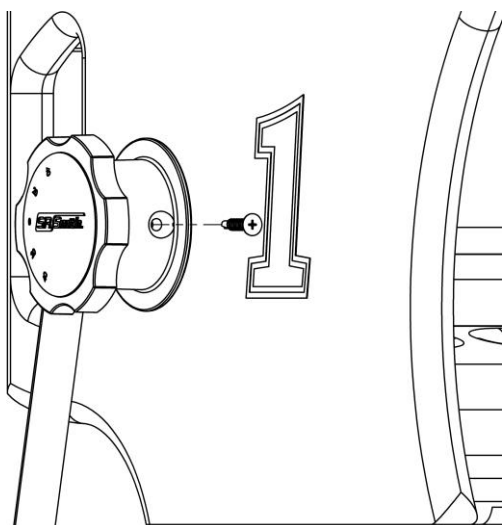

Figure 17 (Left side shown)

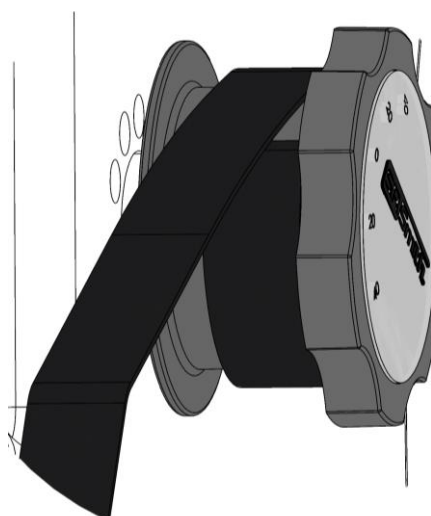

Figure 18

VELOCITY ADVANTAGE WARRANTY & PRODUCT REGISTRATION

INFORMATION/ADVANTAGE INSTALLATION INSTRUCTIONS

Set the backstroke ledge in the pool, looping the strap around and over the spool cap. Ensure adjustment is initially set at 0 as shown in Figure 22 | Left Spool Cap

BACKSTROKE LEDGE ADJUSTMENT

- I. BACKSTROKE LEDGE ADJUSTMENT Figure 23. Verify the top of the ledge is at water level within $\frac{1}{2}$ " (13mm).

Contact either your distributor or S.R. Smith if the strap is too short; we will replace it with one that is the right length for your deck-to-water height.

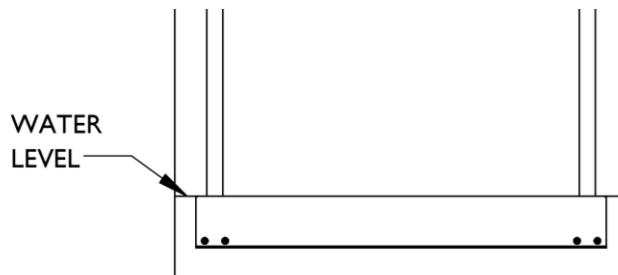

Figure 19 | Backstroke Ledge Alignment

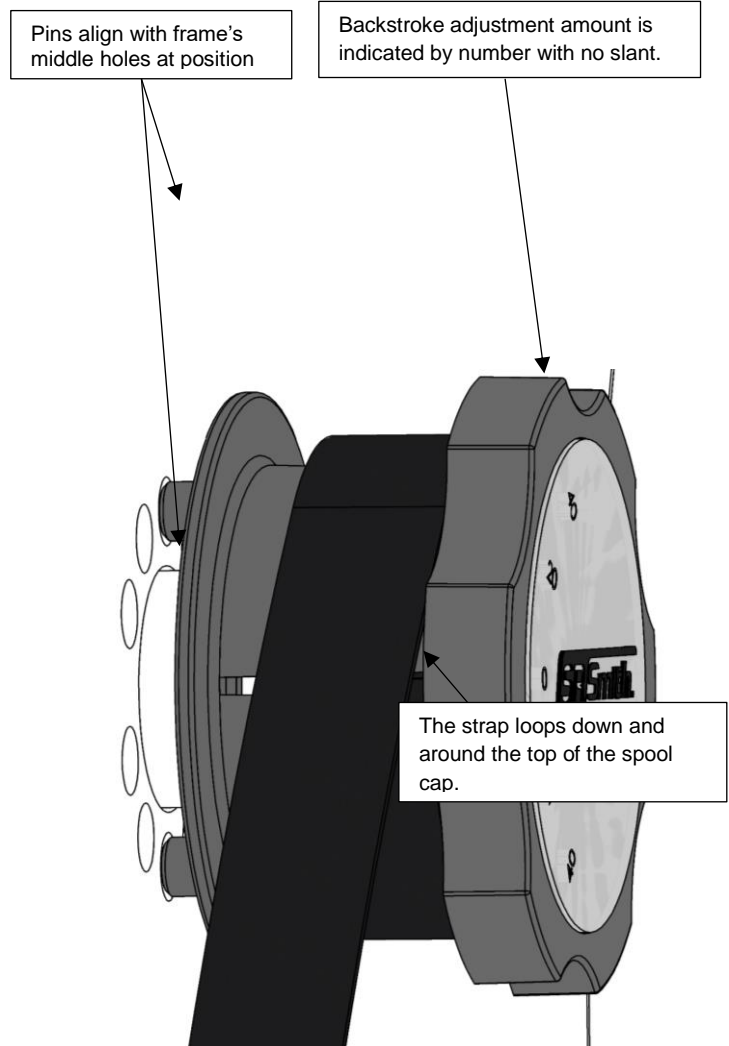

Figure 22 | Left Spool Cap

BACKSTROKE LEDGE ADJUSTMENT

The backstroke ledge can be adjusted 40mm (1.6") above or below the water level in increments of 20mm (5 positions). To adjust the height, follow these instructions:

1. Pull on the left spool cap until the pins are clear of the holes in the frame. The left spool cap is marked with numbers.
2. Rotate the spool to the desired depth. Rotating clockwise will raise the backstroke ledge above water level. Rotating counter-clockwise will lower the backstroke ledge.
3. Align the pins with corresponding holes in the frame and push the left spool cap back in.

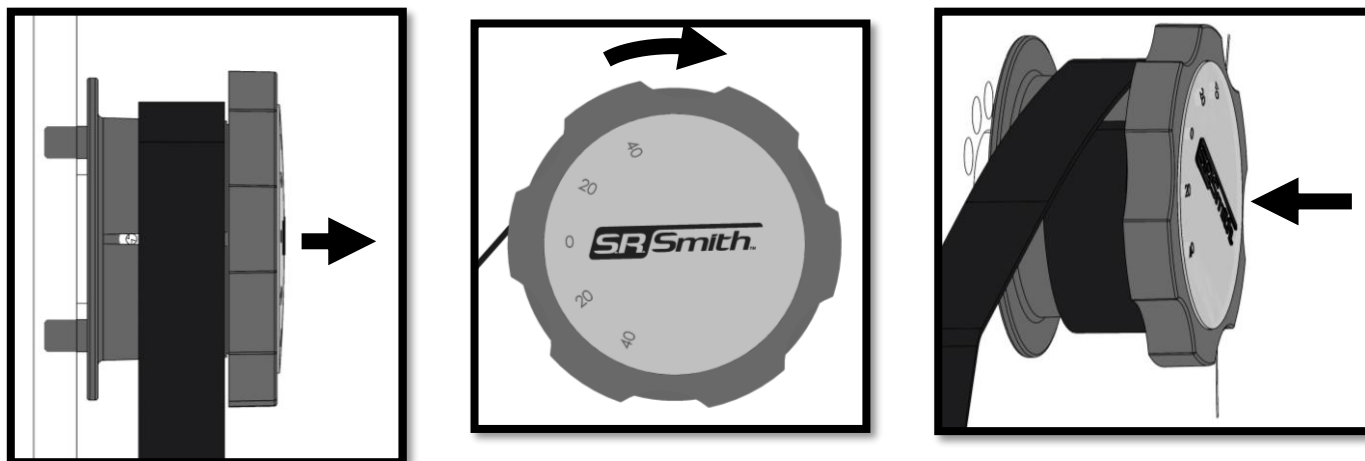

Figure 20 | Backstroke Ledge Adjustment

WARRANTY & PRODUCT REGISTRATION INFORMATION

For warranty information and details, please visit www.srsmith.com/en-us/customer-service/warranty-information/. Register your S.R.Smith product at www.srsmith.com/en-us/customer-service/product-registration



Visit srsmith.com for information on the complete line of S.R.Smith pool products.

SAFETY & MAINTENANCE INSTRUCTIONS

- **Execute shallow racing dives only.**
- For use by trained competitive swimmers only.
- Inspect the Velocity Advantage monthly to assure there are no worn parts and that all hardware is properly tightened.
- To clean, use a multi-purpose cleaner and scrub lightly with a nylon scrubby or brush.